

Spin S

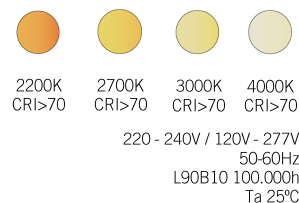

KEY ADVANTAGES

- Integrative aesthetics with any urban space.
- Up to 149lm/ W.
- Up to 11 optical distributions.
- Robust: IP66 + IK10.
- Connection system without opening the luminaire.
- Lifespan L90B10 100.000h a Ta of 25°C.
- Smart Ready: Designed to host both communications node interiors and exteriors.
- Complies with the Zhaga standard.

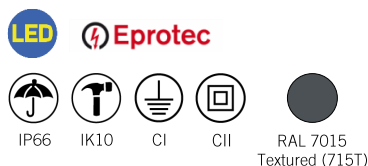

DESCRIPTION

The Spin Series is a family of luminaires with LED technology designed by Carandini that solves different urban lighting applications.

Thanks to its aesthetic design and the different optical distributions, it is perfectly integrated into luminaires of pedestrian areas, urban roads, squares and gardens providing the required light in the right place, thus creating pleasant and safe environments for people.

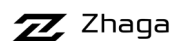
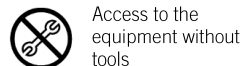
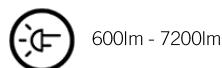

STANDARD COMPLIANCE

- CE
- RoHS
- UNE-EN 60598-1
- UNE-EN 60598-2-3 o 60598-2-5
- UNE-EN 62471:2009
- UNE-EN 60598
- UNE-EN 61000-3-2
- UNE-EN 61000-3-3
- UNE-EN 55015
- UNE-EN 61547
- UNE-EN 62031
- UNE-EN 61347-2-13
- UNE-EN 62384
- UNE-EN 13032-4
- UNE-EN ISO 9227 NSS: 2017 (1000h)

LOGISTICS INFORMATION

- Gross weight: 7,1 Kg
- Units per box: 1 unit
- Box dimensions: 470 x 190 x 160 mm

Measurements carried out in an ISO 17025 accredited laboratory.
Meets the minimum requirements CEI - IDAE.

PHOTOMETRIC DISTRIBUTIONS

It has 11 photometric distributions used for the environments in which this type of luminaire is installed, it can be adapted to all needs:

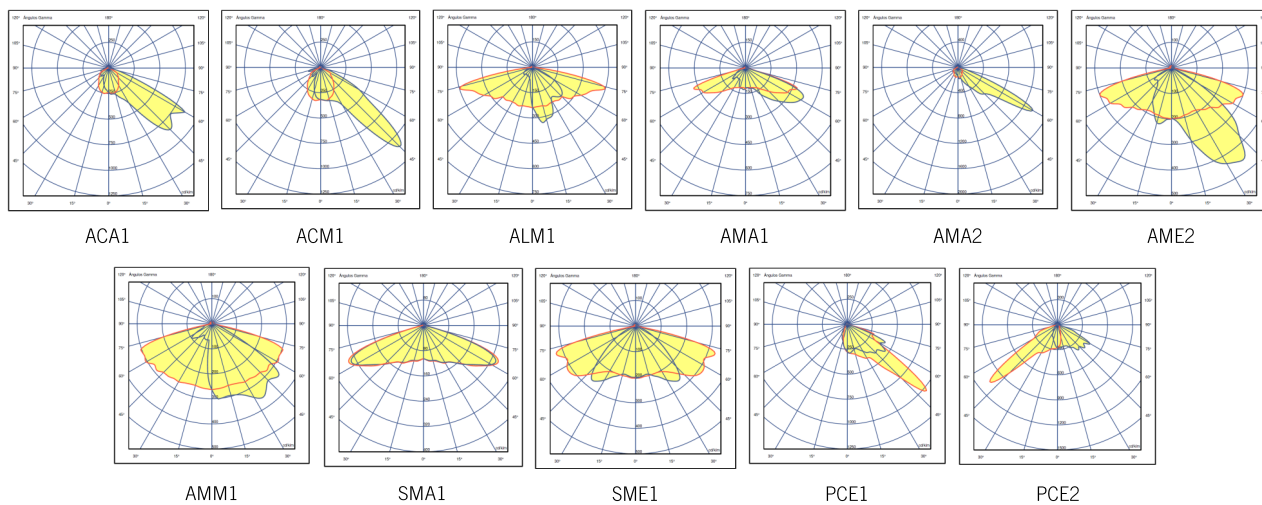

DIMENSIONS

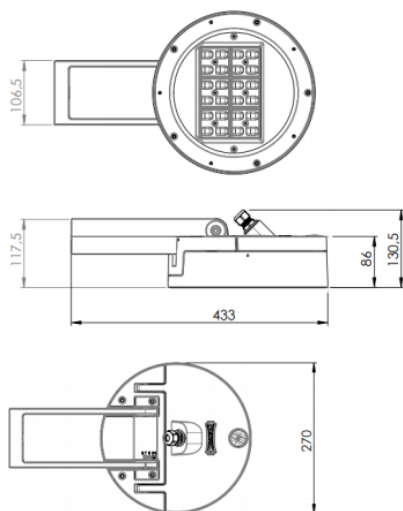

APPLICATIONS

Parks, urban roads, gardens, squares and pedestrian areas.



CHARACTERISTICS SPIN S

GENERAL CHARACTERISTICS	
Armor and fork	Aluminum injected at high pressure EN AC-44300 with low copper content <0.1% (AISI304). It incorporates molded silicone gasket housed in the
Finish	Cover and fork of gray powder paint RAL 7015
Closure	Tempered glass 5mm thick.
Nuts outer and bolts	Stainless steel (AISI304).
Watertightness	IP66 (EN 60598-1 and EN 60598-2-3)
Impact protection grade	IK10 (EN 62262)
Operating temperature	Ta -40°C a +50°C
Lifespan	L90B10 100.000 h. Light maintenance values at 25°C are calculated by

ELECTRICAL CHARACTERISTICS	
Electrical class	Class I o Class II
Voltage / Frequency	220V - 240V / 50Hz - 60Hz Optional 120V - 277V
Power factor	> 0,9
Hermonic distorsion	< 20%
Surge protector	Surge protector (1,2/50) 10 kV. Maximum discharge current (8/20) 10kA. Maximum service voltage (L-N) 320 V.

MAINTENANCE AND ASSEMBLY	
Installation and	Access to the driver without tools and from the top by
Fixation	Cast iron fork for wall or column fixing.
Accessories	C.SENS=> Presence sensor fixed to column.
Weight	6,9 Kg
Pressure compensation valve	The luminaire has a pressure compensation valve that compensates for internal / external system pressure. The integration of the valve extends the projected life of the joints and internal parts by reducing the pressure that is exerted on them and prevents the entry of moisture into the interior that

LIGHT CHARACTERISTICS	
Real lumen package	600 lm to 7200 lm (6 - 53W)
LED color temperature	4.000K (Neutral white, nw). 3.000K (Warm white, ww). 2.700K (Warm white, ww). 2.200K (Warm white, ww).
Colour rendering index (CRI)	CRI>70. Other CRI, consult.
LEDs	It integrates various types of modules of 8,16 and 24
ULOR	Between 0,00% and 0,08%
Optics	Polymethylmethacrylate PMMA.
Photometric distributions	ACA1 => al. longitudinal 10th app. transverse 40° / 60° (Type III) ACM1 => al. longitudinal 15° app. transverse 45° (Type III) ALM1 => al. longitudinal 75° app. transverse 10° / 45° (Type III) AMA1 => al. longitudinal 70° app. Transverse 50° / 65° (Type IV) AMA2 => al. longitudinal 15° app. transversal 60° (Type III) AME2 => al. longitudinal 70° app. transverse 15° / 40° (Type II) AMM1 => al. longitudinal 70° app. transverse 20° / 40° (Type II) SMA1 => al. longitudinal 60° app. transversal 60° (Type VS) SME1 => al. longitudinal 70° app. transverse 40° (Type II) PCE1 => al. longitudinal 50° app. transverse 45° / 55° (Type IV) PCE2 => al. longitudinal 50° app. cross 50° / 60° (Type II)
LED thermal control	Heat dissipation by conduction through the specific design for this luminaire, since it has been designed specifically for LED technology.

MANAGEMENT AND CONTROL	
Equipment	1N: 1 level LED. RC: LED Adjustable in header. AF: LED Adjustable 1-10V Protocol. RD: LED Adjustable DALI Protocol. RL: Adjustable by line.
Autonomus regulation	Factory programmed regulations: 56: 50% of the 24:00h at 6:00h. 66: 60% of the 24:00h at 6:00h. 76: 70% of the 24:00h at 6:00h.
CLO regulation	Flow rate during the life of the product: 7: 70% Luminous flux throughout the life of the luminaire. 8: 80% Luminous flux throughout the life of the luminaire. 9: 90% Luminous flux throughout the life of the luminaire.
Socket	X: Zhaga Socket with cover IP66.
Photocells	Photocell for Zhaga top Socket (20 lux)
Node	BS: Controlux Basic

NOTE: Correct data on the date of printing. The company reserves the right to change the value at any time.

ACCESSORIES

All fixing accessories are mounted together with the standard fork that includes the luminaire.
Standard accessories color: RAL 7015 Textured gray.

Accessories for wall or surface fixing:

FM J6- I

Coupling for wall or surface Code:
318540

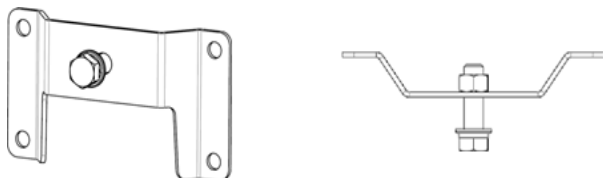

The coupling includes:

- To fix 1 luminaire to the M 16 x 50 mm hexagonal screw coupling and washers.

Accessories for Ø 60 mm columns:

NF60—1

Cast iron coupling to fix 1 luminaire to a 60 mm column
Code: 318492

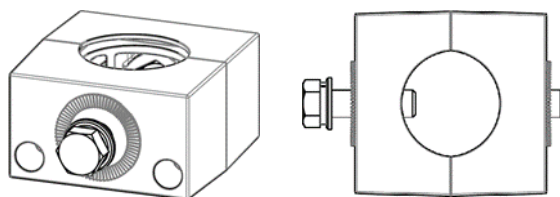

The coupling includes:

Allen screw M8 x 40 mm, washers and Allen stud M 16 x 20 mm

To fix the luminaire to the coupling: M 16 x 50 mm hexagonal screw and washers.

NF60—2

Cast iron coupling to fix 2 luminaires to a 60 mm column
Code: 318493

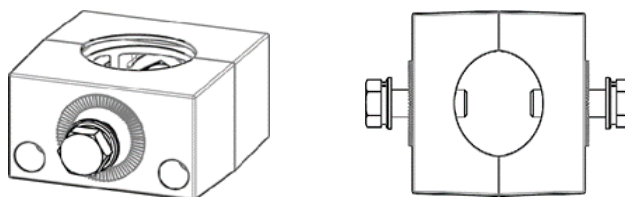

The coupling includes:

Allen screw M8 x 40 mm, and washers.

To fix 2 luminaires to the coupling: M 16 x 10 mm hexagonal screws and washers

Accessories for columns of Ø 76, 101 and 114 mm:

Cast iron knot to fix 1 luminaire

NF76-1: Knot for Ø 76 mm column.
Code: 318531

NF101-1: Knot for Ø 101 mm column.
Code: 318504

NF114-1: Knot for Ø 114 mm column.
Code: 318534

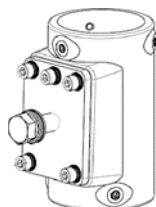

The knot includes:

To fix the knot to the column: Allen studs M8 x 10mm

To fix the luminaire to the knot M16 x 50 mm screw and washers

Cast iron knot to fix 2 luminaires

NF76-2: Knot for Ø 76 mm column.
Code: 318532

NF101-2: Knot for Ø 101 mm column.
Code: 318533

NF114-2: Knot for Ø 114 mm column.
Code: 318535

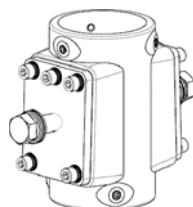

The knot includes:

To fix the knot to the column: Allen studs M8 x 10 mm

To fix the luminaire to the knot M16 x 50 mm screw and washers

Top cap for column

TS76: Top cap for Ø 76 mm column.
Code: 318541

TS101: Top cap for Ø 101 mm column
Code: 318542

TS114: Top cap for Ø 114 mm column
Code: 318543

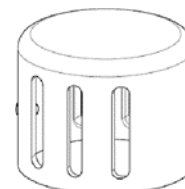

The plug includes

Allen stud M8 x 10 mm to fix to column

ACCESSORIES

C.SENS column presence sensor



PHOTOS SPIN S

