

# Spin M



## KEY ADVANTAGES

- Integrative aesthetics with any urban space.
- Up to 152lm/ W.
- Up to 11 optical distributions.
- Robust: IP66 + IK09.
- Connection system without opening the luminaire.
- Lifespan L90B10 100.000h a Ta of 25°C.
- Smart Ready: Designed to host both communications node interiors and exteriors.
- Complies with the Zhaga standard.



Eprotec



IP66



IK09



CI



CII



RAL 7015  
Textured (715T)



2200K  
CRI>70



2700K  
CRI>70



3000K  
CRI>70



4000K  
CRI>70

220 - 240V / 120V - 277V  
50-60Hz  
L90B10 100.000h  
Ta 25°C

## DESCRIPTION

The Spin Series is a family of luminaires with LED technology designed by Carandini that solves different urban lighting applications.

Thanks to its aesthetic design and the different optical distributions, it is perfectly integrated into luminaires of pedestrian areas, urban roads, plazas and gardens providing the required light in the right place, thus creating pleasant and safe environments for people.



2.500lm - 14.000lm



152lm /W  
Luminary



-40°C - +50°C



7,7 Kg



0,00% - 0,08%



Tool-free access to  
driver

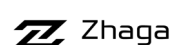

## STANDARD COMPLIANCE

- CE
- RoHS
- UNE-EN 60598-1
- UNE-EN 60598-2-3 o 60598-2-5
- UNE-EN 62471:2009
- UNE-EN 60598
- UNE-EN 61000-3-2
- UNE-EN 61000-3-3
- UNE-EN 55015
- UNE-EN 61547
- UNE-EN 62031
- UNE-EN 61347-2-13
- UNE-EN 62384
- UNE-EN 13032-4
- UNE-EN ISO 9227 NSS: 2017 (1000h)

## LOGISTICS INFORMATION

- Gross weight: 8,1 Kg
- Units per box: 1 unit
- Box dimensions: 470 x 390 x 160 mm

Measurements carried out in an ISO 17025 accredited laboratory.  
Meets the minimum requirements CEI - IDAE.

## PHOTOMETRIC DISTRIBUTIONS

It has 11 photometric distributions used for the environments in which this type of luminaire is installed, it can be adapted to all needs:

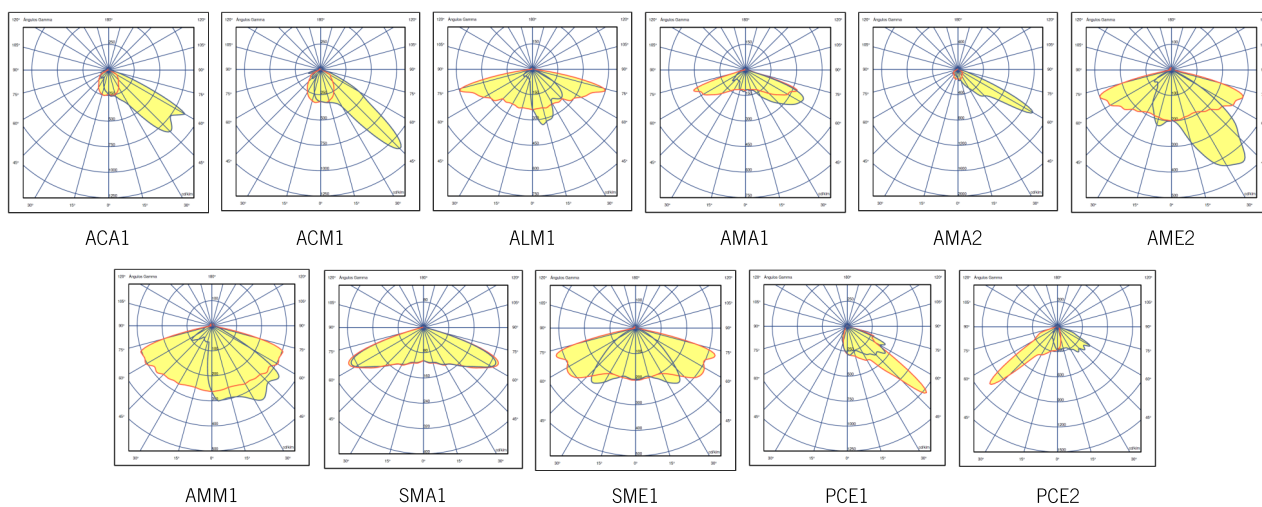

## DIMENSIONS

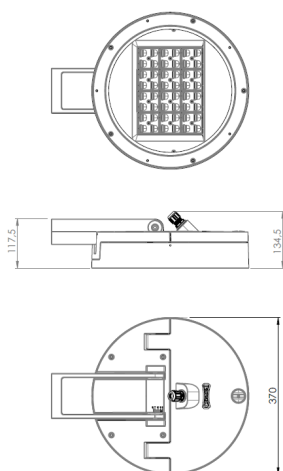

## APPLICATIONS

Parks, urban roads, gardens, squares and pedestrian areas.



## CHARACTERISTICS SPIN M

GENERAL CHARACTERISTICS	
Armor and fork	Aluminum injected at high pressure EN AC-44300 with low copper content <0.1% (AISI304). It incorporates molded silicone gasket housed in the perimeter channel.
Finish	Cover and fork of gray powder paint RAL 7015 Textured (715T).
Clousure	Tempered glass 5mm thick.
Nuts outer and bolts	Stainless steel (AISI304).
Watertightness	IP66 (EN 60598-1 and EN 60598-2-3)
Impact protection grade	IK09 (EN 62262)
Operating temperature	Ta -40°C a +50°C According to luminaire configuration.
Lifespan	L90B10 100.000 h. Light maintenance values at 25°C are calculated by TM-21 in LM-80 database.

ELECTRICAL CHARACTERISTICS	
Electrical class	Class I o Class II
Voltage / Frequency	220V - 240V / 50Hz - 60Hz Optional 120V - 277V
Power factor	> 0,9
Hermonic distorsion	< 15%
Surge protector	Surge protector (1,2/50) 10 kV. Maximum discharge current (8/20) 10kA. Maximum service voltage (L-N) 320 V. Maximum service voltage (L/N-GND) 400 V.

MAINTENANCE AND ASSEMBLY	
Installation and maintenance	Access to the driver without tools and from the top by removing the cover. Materials that do not require maintenance. Cleaning the diffuser with soap and water. IP68 cable and connector ready for installation.
Fixation	Cast iron fork for wall or column fixing.
Accessories	<b>C. SENS</b> => Presence sensor fixed to column. <b>FM16-1</b> => Wall fixing for Spin. <b>NF60-1</b> => Single Spin Ø60mm knot. <b>NF60-2</b> => Double Spin Ø60mm knot.
Weight	7,7 Kg
Pressure compensation valve	The luminaire has a pressure compensation valve that compensates for internal / external system pressure. The integration of the valve extends the projected life of the seals and internal parts by reducing the pressure exerted on them and preventing moisture from entering the interior that can cause condensation.

LIGHT CHARACTERISTICS	
Real lumen package	2.500 lm to 14.000 lm (21 - 103W).
LED color temperature	4.000K (Neutral white, nw). 3.000K (Warm white, ww). 2.700K (Warm white, ww). 2.200K (Warm white, ww). Température ambre, consulter.
Colour rendering index (CRI)	CRI>70. Other CRI, consult.
LEDs	It incorporates 32 and 48 LED.
ULOR	Between 0,00% and 0,08%
Optics	Polymethylmethacrylate PMMA.
Photometric distributions	<b>ACA1</b> => Throw 10° spread 45°/60° (Type III) <b>ACM1</b> => Throw 15° spread 45° (Type II) <b>ALM1</b> => Throw 75° spread 10°/45° (Type III) <b>AMA1</b> => Throw 70° spread 50°/65° (Type IV) <b>AMA2</b> => Throw 15° spread 60° (Type III) <b>AME2</b> => Throw 70° spread 15°/40° (Type II) <b>AMM1</b> => Throw 70° spread 35°/55° (Type III) <b>SMA1</b> => Throw 65° spread 65° (Type VS) <b>SME1</b> => Throw 70° spread 40° (Type II) <b>PCE1</b> => Throw 50° spread 45°/55° (Type III) <b>PCE2</b> => Throw 50° spread 50°/60° (Type III)
LED thermal control	Heat dissipation by conduction through the specific design for this luminaire, since it has been designed specifically for LED technology.

MANAGEMENT AND CONTROL	
Equipment	<b>1N:</b> 1 level LED. <b>RC:</b> LED Adjustable in header. <b>AF:</b> LED Adjustable 1-10V Protocol. <b>RD:</b> LED Adjustable DALI Protocol. <b>RL:</b> Adjustable by line. <b>2N:</b> Double level.
Autonomus regulation	Factory programmed regulations: <b>56:</b> 50% of the 24:00h at 6:00h. <b>66:</b> 60% of the 24:00h at 6:00h. <b>76:</b> 70% of the 24:00h at 6:00h. <b>SC:</b> Programming according to client.
CLO regulation	Flow rate during the life of the product: <b>7:</b> 70% Luminous flux throughout the life of the luminaire. <b>8:</b> 80% Luminous flux throughout the life of the luminaire. <b>9:</b> 90% Luminous flux throughout the life of the luminaire.
Socket	<b>U:</b> NEMA Socket 3 pin with cover IP65. <b>V:</b> NEMA Socket 5 pin with cover IP65. <b>W:</b> NEMA Socket 7 pin with cover IP65. <b>X:</b> Zhaga Socket 4 pin with cover IP66.
Photocells	Photocells for NEMA Socket 3, 5 and 7 pin (20 lux) Photocell for Zhaga top Socket (20 lux)
Node	<b>ON:</b> Controlux One <b>BS:</b> Controlux Basic

**NOTE:** Correct data on the date of printing. The company reserves the right to change the value at any time.

## ACCESSORIES

All fixing accessories are mounted together with the standard fork that includes the luminaire.  
Standard accessories color: RAL 7015 Textured gray.

### Accessories for wall or surface fixing:

FM J6- I

Coupling for wall or surface Code:  
318540

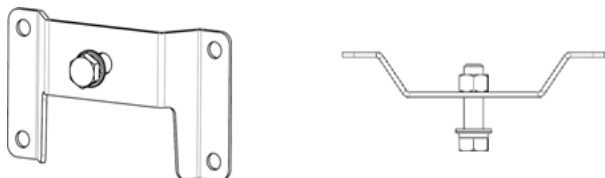

The coupling includes:

- To fix 1 luminaire to the M 16 x 50 mm hexagonal screw coupling and washers.

### Accessories for Ø 60 mm columns:

NF60—1

Cast iron coupling to fix 1 luminaire to a 60 mm column  
Code: 318492

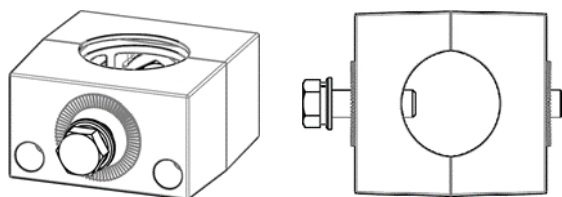

The coupling includes:

Allen screw M8 x 40 mm, washers and Allen stud M 16 x 20 mm

To fix the luminaire to the coupling: M 16 x 50 mm hexagonal screw and washers.

NF60—2

Cast iron coupling to fix 2 luminaires to a 60 mm column  
Code: 318493

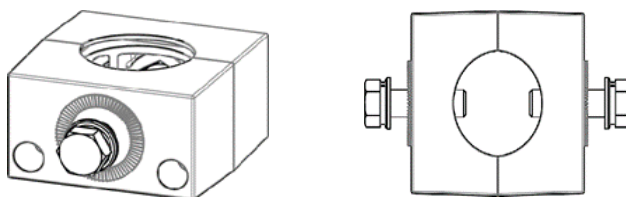

The coupling includes:

Allen screw M8 x 40 mm, and washers.

To fix 2 luminaires to the coupling: M 16 x 10 mm hexagonal screws and washers

### Accessories for columns of Ø 76, 101 and 114 mm:

Cast iron knot to fix 1 luminaire

**NF76-1:** Knot for Ø 76 mm column.  
Code: 318531

**NF101-1:** Knot for Ø 101 mm column.  
Code: 318504

**NF114-1:** Knot for Ø 114 mm column.  
Code: 318534

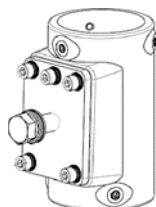

The knot includes:

To fix the knot to the column: Allen studs M8 x 10mm

To fix the luminaire to the knot M16 x 50 mm screw and washers

Cast iron knot to fix 2 luminaires

**NF76-2:** Knot for Ø 76 mm column.  
Code: 318532

**NF101-2:** Knot for Ø 101 mm column.  
Code: 318533

**NF114-2:** Knot for Ø 114 mm column.  
Code: 318535

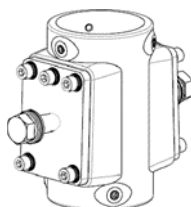

The knot includes:

To fix the knot to the column: Allen studs M8 x 10 mm

To fix the luminaire to the knot M16 x 50 mm screw and washers

Top cap for column

**TS76:** Top cap for Ø 76 mm column.  
Code: 318541

**TS101:** Top cap for Ø 101 mm column  
Code: 318542

**TS114:** Top cap for Ø 114 mm column  
Code: 318543

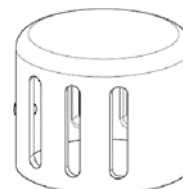

The plug includes

Allen stud M8 x 10 mm to fix to column

## ACCESSORIES

C.SENS column presence sensor



## PHOTOS SPIN M

